

# BARONESS SURREY

**PRODUCT:** BARONESS SURREY

**CODE:** 07

**DIMENSIONS:** 47"H X 6.5"D X 35.5"W

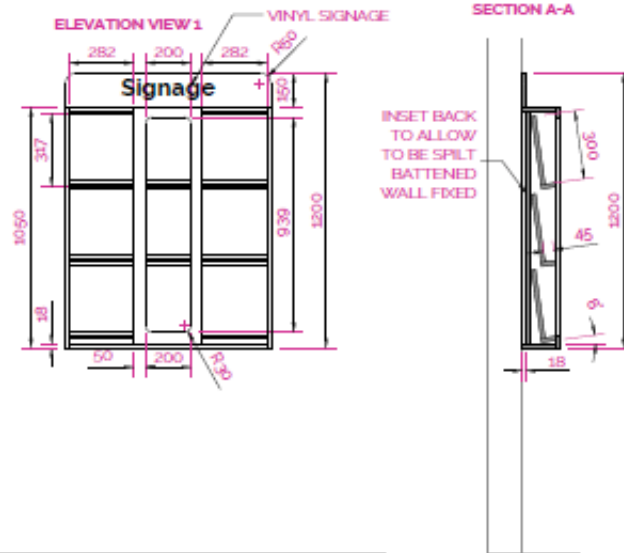
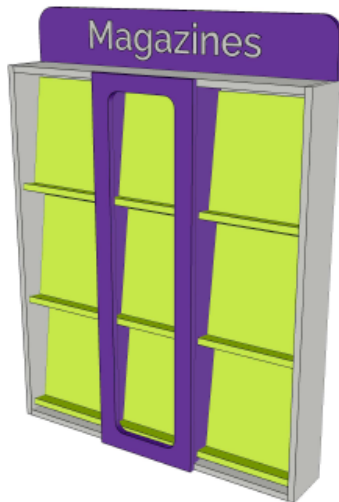

## **SPECIFICATIONS:**

### **WALL MOUNT:**

This shelving unit is wall mounted.

### **DESCRIPTIONS:**

Baron & Baroness shelving is brightly coloured, multipurpose library shelving in several configurations for the modern library, designed to hold books and multimedia materials.

### **CONSTRUCTION:**

Baron & Baroness shelving units have steel and MFC construction, painted with epoxy paint finish.

Some Baron & Baroness have padded seats (from the variety of upholstered or Just Colour vinyl range) and made of MFC construction.



**Nansen Group Inc.**  
SUITE 207 264 Midpark Way SE  
Canada

| Calgary , Alberta,

[www.nansengroup.com](http://www.nansengroup.com) | [sales@nansengroup.net](mailto:sales@nansengroup.net)